



## ROAD TRAFFIC REGULATION (NORTHERN IRELAND) ORDER 1997 (as amended)

### APPLICATION TO HOLD A SPECIAL EVENT ON A PUBLIC ROAD

**Please read the following guidance documents before submitting your application.**

- Department for Infrastructure 'Guidance for Promoters of Events'
- Attached Council guidance notes on completion of this application form

<b>ABOUT YOU</b>	
Name of Promoter	
Address of Promoter	
	Postcode:
Name of contact (s)	Telephone:
Position / role of contact	E-Mail:
Confirm if you have authority to act on behalf of the Promoter	Yes No
<b>ABOUT THE EVENT</b>	
Name of Event	Armagh Georgian Day
Date of event	Fri. 29.11.24 & Sat. 30.11.24
Purpose and nature of event	Georgian Day is an ABC Council Signature Event held on the last Saturday of November each year. This event is craft and food and a celebration of Armagh City's Georgian architecture and heritage. The event attracted approximately 35,000 visitors in 2023. The event is a huge boost to the retailers in Armagh City Centre. The main elements will include the opening of key Georgian properties, Georgian Carriage rides, food and craft stalls, walking tours, music and festive fayre, Children's entertainment, silhouette cutter, Georgian themed workshops, lectures and talks, Shades of the Past lighting project. The spectacular light show projected onto the Georgian facade of Armagh City Library will run on Friday 29 <sup>th</sup> November and again on Saturday 30 <sup>th</sup> November. It is anticipated that retailers will open late on both evenings. We will have stalls both on the Mall and in the City Centre – Scotch Street, Thomas Street, Market Street, Upper English Street and Russell Street. The management and safety of the crowds attending the events will require the closing of streets
Have all other options for holding the event off the public road been explored?	Yes No
Is this a 'small event'?	Yes No
Public liability insurance details	Armagh City Banbridge & Craigavon Borough Council insurance
<b>POSSIBLE IMPACT</b>	
1. Name of road (s) on which event is to be held. (Enclose a detailed, marked up location plan to include marshals / stewards & first aid positions)	Ogle Street, Thomas Street, Scotch Street, Market Street, Castle Street, Upper English Street, Russell Street, Mall East
2. Please list all roads to be signed as diversionary routes. (Use separate sheet if necessary)	As per TMP

3. Type of restriction (full road closure / lane restriction etc.)	One lane closure on Mall East and the remainder is Full Road Closure		
4. Date and Start / End times of proposed road restriction	Date: 29.11.24 Date: 01.12.24 Please note that not all of the roads will be closed for the entire duration – see TMP for exact timings on each road	Start Time: 15:00	End Time: 01:00
5. Name of company undertaking the Traffic Management Plan including a signing schedule?	Grahames Asset Management		
6. Name of company undertaking signage work for the event (Appendix A)	Grahames Asset Management		
7. Has this event been held previously?	Yes <del>No</del>		
8. If yes, are the previous arrangements amended in any way? Provide details.	Yes <del>No</del> Not applicable  This is the same as last year with one addition to allow access to St. Patrick's Trian car park.  Two-way traffic system in connection with Junction of College Hill/Upper English Street, turning left from College Hill onto Upper English Street to the St. Patricks Trian Car Park – in place 7.00am – 11.00pm.  PSNI suggested the following wording: With regards to access to the Trian car-park, you could use the following form of words – 'a temporary reversal of one way traffic flow' from the Junction of College Hill/Upper English Street, turning left from College Hill onto Upper English Street to the St. Patricks Trian Car Park (car-park approx. 30 metres from the junction of College Hill/Upper English Street). Traffic Management Company should have car-park signs that they will place out along College Hill.		
9. Please give details of any structure or equipment to be erected on the public road as part of the event	50 3 x 3m marquees located on one lane Mall East 50 3 x 3m marquees located across Russell Street, Upper English Street, Market Street, Scotch Street & Thomas Street		
10. Provide details of any businesses and residents which may be affected by the event and provide confirmation that they have been contacted	Residents and businesses on Mall East, Charlemont Gardens, Russell Street, Market Street, Upper English Street, Jenny's Row, Scotch Street, Thomas Street, Ogle Street and Castle Street area. They will all receive letters informing them of the closures.		
11. Is a bus route affected (public and / or Education Authority)	NO		
12. Will the Council's waste collection service be affected?	NO		
13. Please detail the arrangements for cleaning up after the event.	Councils litter team on site for build up, duration of event & event breakdown. A litter plan is in place for the entire event.		
14. Provide any other information that may assist with processing your request			

**DECLARATIONS**

- I confirm that I have read the Department for Infrastructure 'Special Events on Roads - Guidance for Promoters of Events' and understand that the Council may apply all or any of the conditions as it deems necessary.
- I also understand that the Council may request any further information that it considers necessary to process this application and that my application may not proceed if I fail to produce this additional information.
- I acknowledge that Armagh City, Banbridge and Craigavon Borough Council is the data controller and data processor under General Data Protection Regulation (GDPR). The Council is collecting this personal information to assist the Environmental Health Department to carry out its statutory duties. The personal data may be shared internally within the Council with staff who are involved in providing this service and where necessary, between internal departments with the purpose of supporting an effective delivery of service. Information collected will only be shared with other Statutory Agencies for lawful purposes or to fulfil statutory obligations. The information you provide will be held securely and in accordance with the Council's Retention and Disposal Schedule. We would like you to be aware that for some legislation, this information may need to be on a register to which others can have access to by request. Further information can be viewed at <https://www.armaghbanbridgecraigavon.gov.uk> or obtained from the Senior Records Officer at the Council.
- I understand I will be required to provide appropriate **Public Liability** insurance cover for this event.
- I confirm that I have consulted with local residents, businesses and relevant service providers that may be affected by the holding of this event.
- I can confirm the details provided in this application are true and correct.

Signature of applicant \_\_\_\_\_ (on behalf of the Promoter)

Date of application 30.05.24

Checklist:	Yes
Application fee - £281 *	
Location plan / map showing marshals / stewards & first aid positions	
Traffic Management Plan including Signing Schedule	
Proof of Company's Competency to produce a Traffic Management Plan (e.g. Lantra sector 12 D (M7) or equivalent)	
Details of Consultees and feedback received (bus providers, residents, businesses)	

\* Please refer to relevant point in attached guidance notes regarding small events

Please return the completed application form, accompanying documents and fee to:

Environmental Health Dept Old Armagh City Hospital 39 Abbey Street Armagh BT61 7DY	Environmental Health Dept Civic Building, Downshire Road, Banbridge, BT32 3JY	Environmental Health Dept Civic & Conference Centre, PO Box 66, Lakeview Road, Craigavon, BT64 1AL
---	--	---

T: 0330 0561 011 E: [ehhealth@armaghbanbridgecraigavon.gov.uk](mailto:ehhealth@armaghbanbridgecraigavon.gov.uk)

[www.armaghbanbridgecraigavon.gov.uk](http://www.armaghbanbridgecraigavon.gov.uk)

**GUIDANCE NOTE TO ACCOMPANY APPLICATION FORM TO HOLD A SPECIAL EVENT ON A PUBLIC ROAD***Please also read the Department for Infrastructure 'Guidance for Promoters of Events'*

<b>ABOUT YOU</b>	
Name of Promoter	Person, company, club or society organising the event
Address of promoter	
Name of contact (s)	
Position/role of contact	
Confirm if you have authority to act on behalf of the Promoter	Yes    No
<b>ABOUT THE EVENT</b>	
Name of Event	The name the event is being advertised under
Date of event	Council usually require a minimum of 12 weeks' notice to process your application
Purpose and nature of event	Provide a full description of the proposed event
Have all other options for holding the event off the public road been explored?	Detail the reasons why this event cannot take place on other than a public road – consideration should be given to grassed areas / local community & activity centres / private land and sports grounds.
Is this a 'small event'?	<p>Small events may be exempt from the application fee. In order to be considered a "small event", the following criteria must be met: -</p> <ol style="list-style-type: none"> <li>1. The event must only be held on minor residential roads e.g. cul-de-sacs, side streets or within a defined housing development</li> <li>2. The road to be closed must not have a bus route along it.</li> <li>3. The road to be closed must not have a car park located on it or which is accessed via the road to be closed (other than one for residents of the road)</li> <li>4. Be an event which would meet the criteria of the Council's Financial assistance policy for community events, insofar as <ol style="list-style-type: none"> <li>a. The event must be organised by a formally constituted group</li> <li>b. The event must not discriminate against Section 75 groups (eg between persons of different religious belief, political opinion, race etc)</li> <li>c. The event must not be for personal or business gain</li> </ol> </li> <li>5. The event must finish by 11 pm.</li> <li>6. The event must have no fireworks, pyrotechnics or bonfires on the street.</li> </ol>
<b>Public liability insurance details</b>	An Order may not be granted without insurance cover being in place

POSSIBLE IMPACT	
1. Name of road(s) on which event is to be held. (Enclose a detailed, marked up location plan to include marshals / stewards and first aid positions)	Organisers must identify the exact roads / streets affected including the start and end locations and provide a marked up plan / drawing to indicate same. The plan must show the length of road to be prohibited or restricted in use ( <b>indicated in red</b> ) and the proposed diversion route ( <b>indicated in green</b> ). This plan must be clear and indicate road names. It should also include positions of marshals / stewards and first aid positions to inform Council's consultees.
2. Please list all roads which will be signed as diversionary routes.	Provide a separate sheet if necessary and ensure that the names of all the roads / streets are included.
3. Type of restriction (full road closure/lane restriction etc.)	Please list the name of roads / street closures and the type of restriction including full road closure, lane restriction, prohibition of certain types of vehicles and footway closures. Pedestrian access to be maintained on all roads / streets on which the event is being held.
4. Date and Start / End times of proposed road restriction	It is important to quote the exact day, date and start / finish times of the proposed restriction for the event
5. Name of company undertaking the Traffic Management Plan including a signing schedule?	The Traffic Management Company producing the Traffic Management Plan must be competent to undertake this work e.g. Lantra sector 12 D (M7) or equivalent. A list of authorised companies can be found on the Department for Communities website using the following link: <a href="https://www.infrastructure-ni.gov.uk/infrastructure/road-works/road-works-signage">Approved Traffic Management Companies for Temporary Signing on public roads   Department for Infrastructure (infrastructure-ni.gov.uk)</a>
6. Name of company undertaking signage work for the event	The company undertaking all signage work for the event should be suitably qualified. The Department for Infrastructure has authorised a number of companies in terms of accreditations and insurance (see above link).
7. Has this event been held previously?	Provide relevant details.
8. If yes, are the previous arrangements amended in any way? Provide details	Yes / No / Not applicable If Yes, detail amendments.
9. Please give details of any structure or equipment to be erected on the public road as part of the event	Please detail methods to be employed to protect road surfaces. Depending on the structure or equipment being placed, technical approvals / safety certificates for any structure erected may also be required (e.g. stage)
10. Please give details of any businesses and residents which may be affected by the event and provide confirmation that they have been contacted	Provide evidence that you have contacted residents, businesses etc. which may be affected by the proposed special event – this may include copy letters / flyers.
11. Is a bus route affected (public and / or Education authority)	If your event affects bus routes, you should explain what arrangements have been made to help reduce adverse impact to bus services.
12. Will the Council's waste collection service be affected?	If your event affects the Council's waste collection service for that route, you should explain what arrangements have been made with Council to help reduce impact to this service.
13. Please detail the arrangements for cleaning up after the event	
14. Provide any other information that may assist with processing your request	



## **Road Closures: GEORGIAN FESTIVAL 2024**

- Castle Street closed on Friday 29<sup>th</sup> November and on Saturday 30<sup>th</sup> November from 3.00pm until 9.00pm each day. Council will, however, facilitate residents who need access during these hours. There will be no traffic allowed in the area at the top of Market Square i.e. from Castle Tower Restaurant to just above the entrance to the Market Place Theatre Private Car Park.
- Market Street through to Upper English Street junction with Russell Street closed Friday 29<sup>th</sup> November from 3.00pm until Sunday 1<sup>st</sup> December at 01:00am. *Some deliveries may be facilitated on request.*
- Upper English Street from junction of Russell Street to entrance of St. Patrick's Trian/Market Place Theatre Car Park Closed on Friday 29<sup>th</sup> November at 6.00pm until Sunday 1<sup>st</sup> December at 01:00am. *Some deliveries may be facilitated on request.*
- To allow access to the St. Patrick's Trian/Market Place Theatre Car Park on Upper English Street during its opening hours (9.00am – 8.30pm) on Saturday 30<sup>th</sup> November, a temporary reversal of one way traffic flow' from the Junction of College Hill/Upper English Street, turning left from College Hill onto Upper English Street to the St. Patrick's Trian/Market Place Theatre Car Park (car-park approx. 30 metres from the junction of College Hill/Upper English Street)
- Top of Jenny's Row Closed on Friday 29<sup>th</sup> November at 6.00pm until Sunday 1<sup>st</sup> December at 01:00am.
- Russell Street Closed on Friday 29<sup>th</sup> November at 6.00pm until Sunday 1<sup>st</sup> December at 01:00am. *Some deliveries may be facilitated on request.*
- Mall East lane closure (Lane next to Mall green) traffic enter from College Hill end, one way from Friday 29<sup>th</sup> November at 6.00pm until Sunday 1<sup>st</sup> December at 01:00am.
- Scotch Street, Thomas Street and Ogle Street will be closed on Friday 29<sup>th</sup> November at 6.00pm until Sunday 1<sup>st</sup> December at 01:00am





**ROAD  
CLOSED HERE  
29/11/24 - 15:00  
TO 30/11/24 - 23:00**

**ADVANCE NOTICE  
SIGNS TO BE  
INSTALLED ON ALL  
ROADS 1 WEEK  
BEFORE EVENT**

REVIEW	EVENT
<b>GRAHAM</b>	
<b>ABC BOROUGH COUNCIL</b>	
<b>ARMAGH GEORGIAN DAY TRAFFIC MANAGEMENT DETAILS TM SETUP FOR EVENT</b>	
1. ARE ADVANCED NOTICE SIGNAGES SHOWN?	Y/N
2. ARE RELEVANT DISCLOSURES SHOWN?	Y
3. ARE PPE LOCATIONS SHOWN?	N/A
4. ARE WORKALLOTTMENTS SHOWN AT ROAD CLOSED SIGHT?	Y
5. ARE CRITICAL LOCATIONS SHOWN AT CENTRAL USE?	Y
<ul style="list-style-type: none"> <li>● Marshalls at Road Closed Signs</li> <li>● Marshalls at Advance notice of permitted movements</li> <li>● no vehicles allowed onto restriction route from a side street</li> <li>● Marshalls at Centre Lane Closing</li> <li>● Marshalls at Advance notice of permitted movements - 1</li> <li>● Marshalls at Advance notice of permitted movements - 2</li> </ul>	
<b>EVENT ORGANISER</b>	
EVENT TRAFFIC MANAGEMENT DOES NOT COMPLY WITH CAE PLEASE REFER TO CLAUSE 3.5 OF OUR TERMS OF BUSINESS FOR FURTHER INFORMATION	
N.T.S.	17/08/2022
JCH	A3
ABCBC - GEORGIAN DAY - ADVANCE SIGNS	
<b>0</b>	

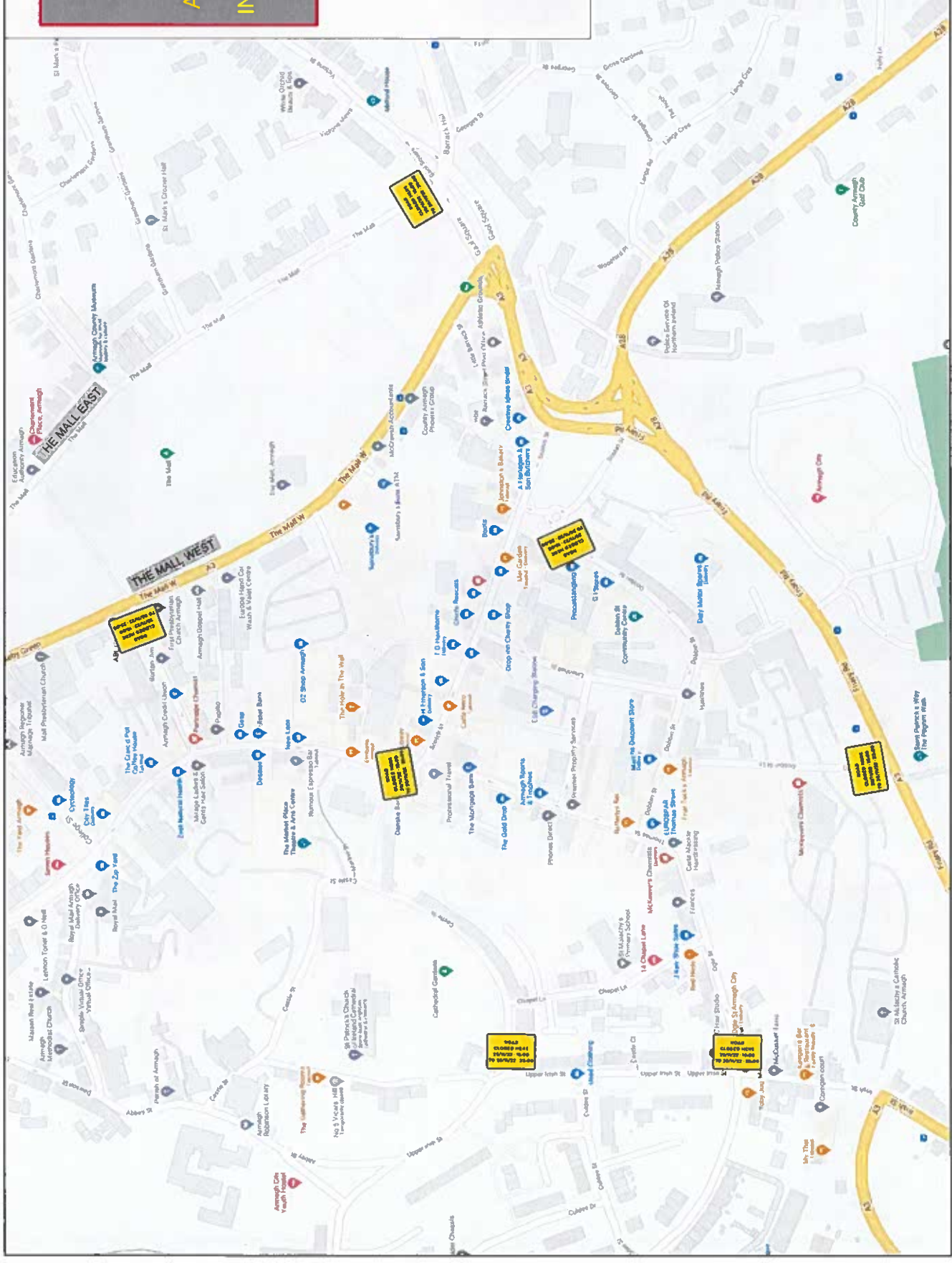

**KEY**

- Traffic cone
- Diversion Route
- Road Closure
- Installed daily from 3pm to 9pm on Fri 29th and Sat 30th
- Installed from Fri 29th at 6pm to Sun 1st Dec at 11am

**RIGHT TURN  
POCKET CONING  
10 CONES**

**50 POLICE  
CONES**

**MARKET  
ST  
CLOSED AT  
3PM - 29/11**

**CENTRE LINE  
CONING  
15 CONES**

**TEMP. REVERSAL OF ONE  
WAY SYSTEM SEE DRAWING  
ABCBC - GEORGIAN DAY - 04**

<b>REVIEW</b>	<b>EVENT</b>
<b>GRAHAM</b>	<b>ABC BOROUGHCOUNCIL</b>
<b>ARMAGH GEORGIAN DAY</b>	
<b>TRAFFIC MANAGEMENT DETAILS</b>	
<b>TM SETUP FOR EVENT</b>	
1. ARE ADVANCED NOTICE SIGNAGES SHOWN?	Y/N
2. ARE RELEVANT OCCUPANCIES SHOWN?	Y
3. ARE PPE LOCATIONS SHOWN?	N/A
4. ARE EMERGENCY LOCATIONS SHOWN AT ROAD CLOSURE?	Y
5. ARE MARSHALL LOCATIONS SHOWN AT CENTRE LINE CONING?	Y
<p>Marshalls at Road Closed Signs Marshalls at Road Closed Signs Marshalls at Centre Line Coning Marshalls to advance movement of permitted movements - e vehicles from side streets only allowed to turn left</p>	
<p><b>EVENT ORGANISER</b> EVENT TRAFFIC MANAGEMENT DOES NOT COMPLY WITH CH 4. PLEASE REFER TO CLAUSE 2.5 OF OUR TERMS OF BUSINESS FOR FURTHER INFORMATION</p>	
N.T.S. 17/06/2022	JCH
ABCBC - GEORGIAN DAY - 01	0

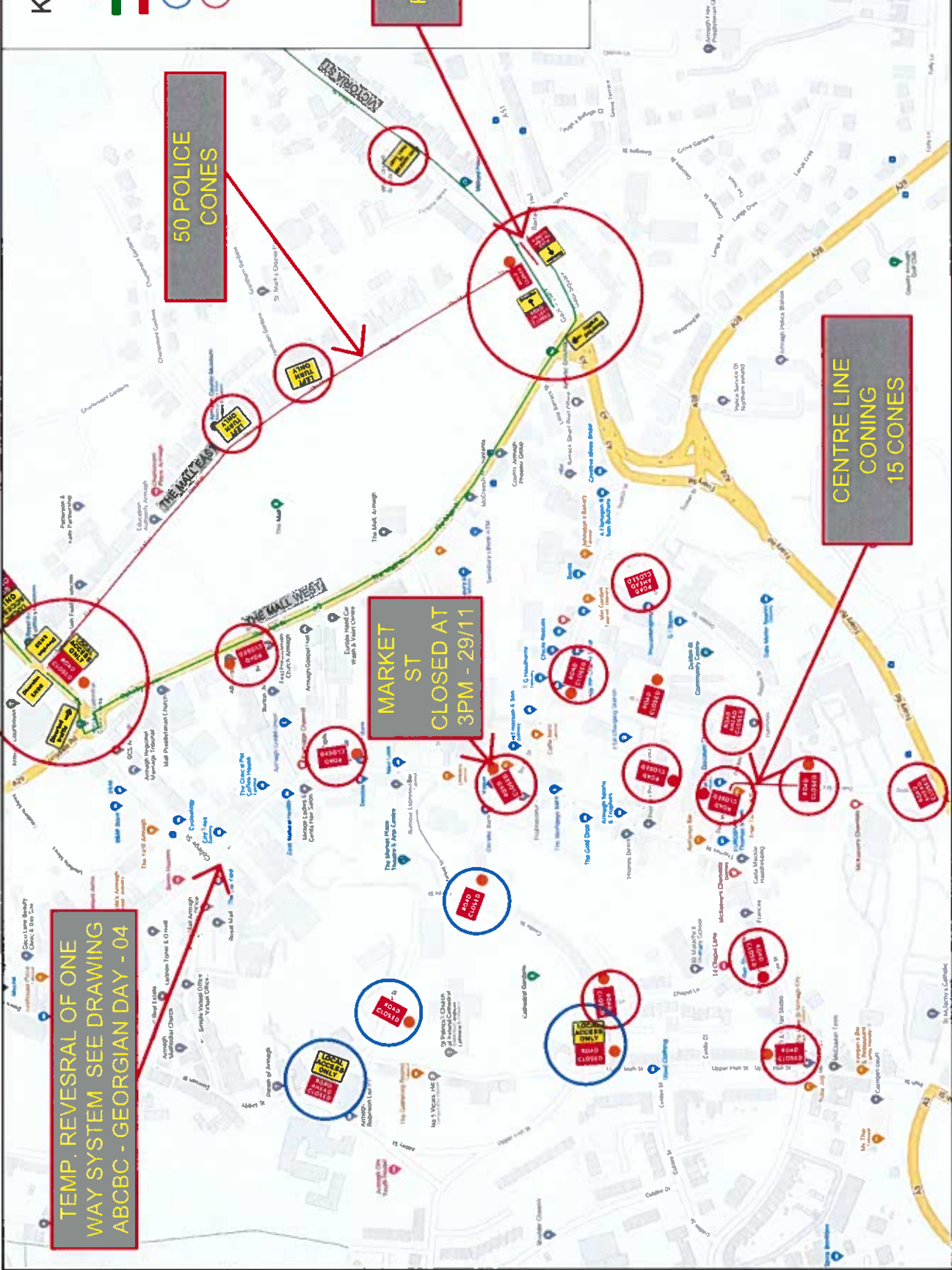



# KEY

- Traffic cone
- Diversion Route
- Road Closure
- Installed daily from 3pm to 9pm on Fri 29th and Sat 30th
- Installed from Fri 28th at 6pm to Sun 1st Dec at 1am

REVIEW EVENT



ABC BOROUGH COUNCIL

ARMAGH GEORGIAN DAY  
TRAFFIC MANAGEMENT DETAILS  
TM SETUP FOR EVENT

MARKER TYPE	Y/N	EVENT
1-LANE ADVANCED NOTICE SIGNPOSTS SHOWN?	Y	
2-LANE RELEVANT DISCLOSURES SHOWN?	Y	
3-LANE PINK LOCATIONS SHOWN?	N/A	
4-LANE MARSHALL LOCATIONS SHOWN AT ROAD CLOSED SIGNS?	Y	
5-LANE MARSHALL LOCATIONS SHOWN AT CENTRE LINE SIGNS?	Y	

● Marshalls at Road Closed Signs  
● Marshalls to advise movements of permitted movements  
● no vehicles allowed onto diversion route from a side street  
● Marshalls at Centre Line Closing  
● Marshalls to advise movements of permitted movements  
● Marshalls to advise movements of permitted movements  
● Marshalls to advise movements of permitted movements

**EVENT ORGANISER**  
 EVENT TRAFFIC MANAGEMENT DOES NOT COMPLY WITH CH 8. PLEASE REFER TO CLAUSE 2.3 OF OUR TERMS OF BUSINESS FOR FURTHER INFORMATION

N.I.S.	17/06/2022	JCH	A3
ABCBC - GEORGIAN DAY - 02			

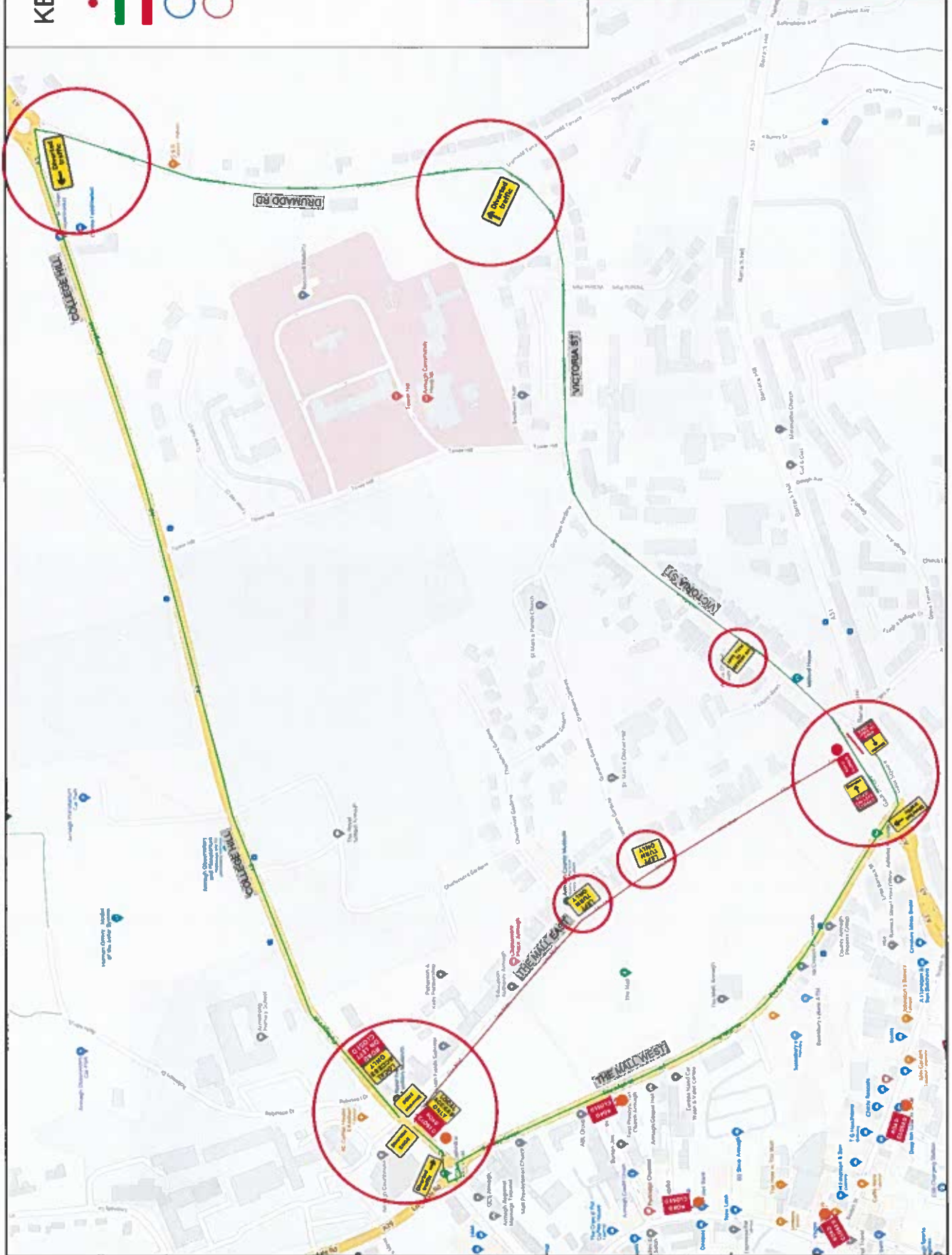

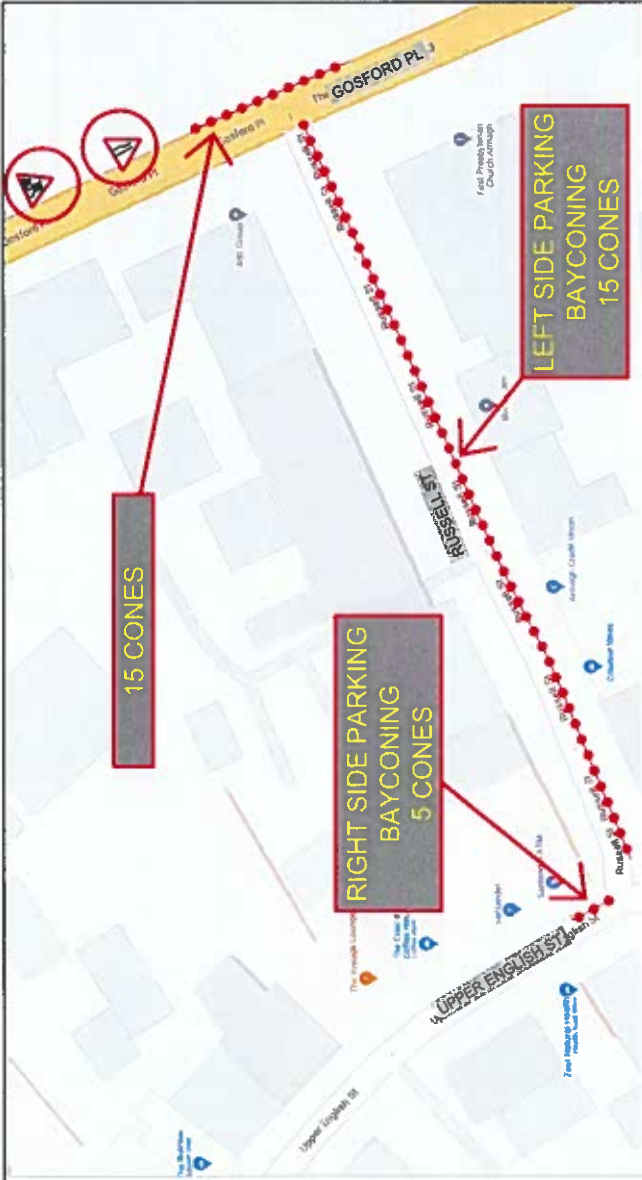
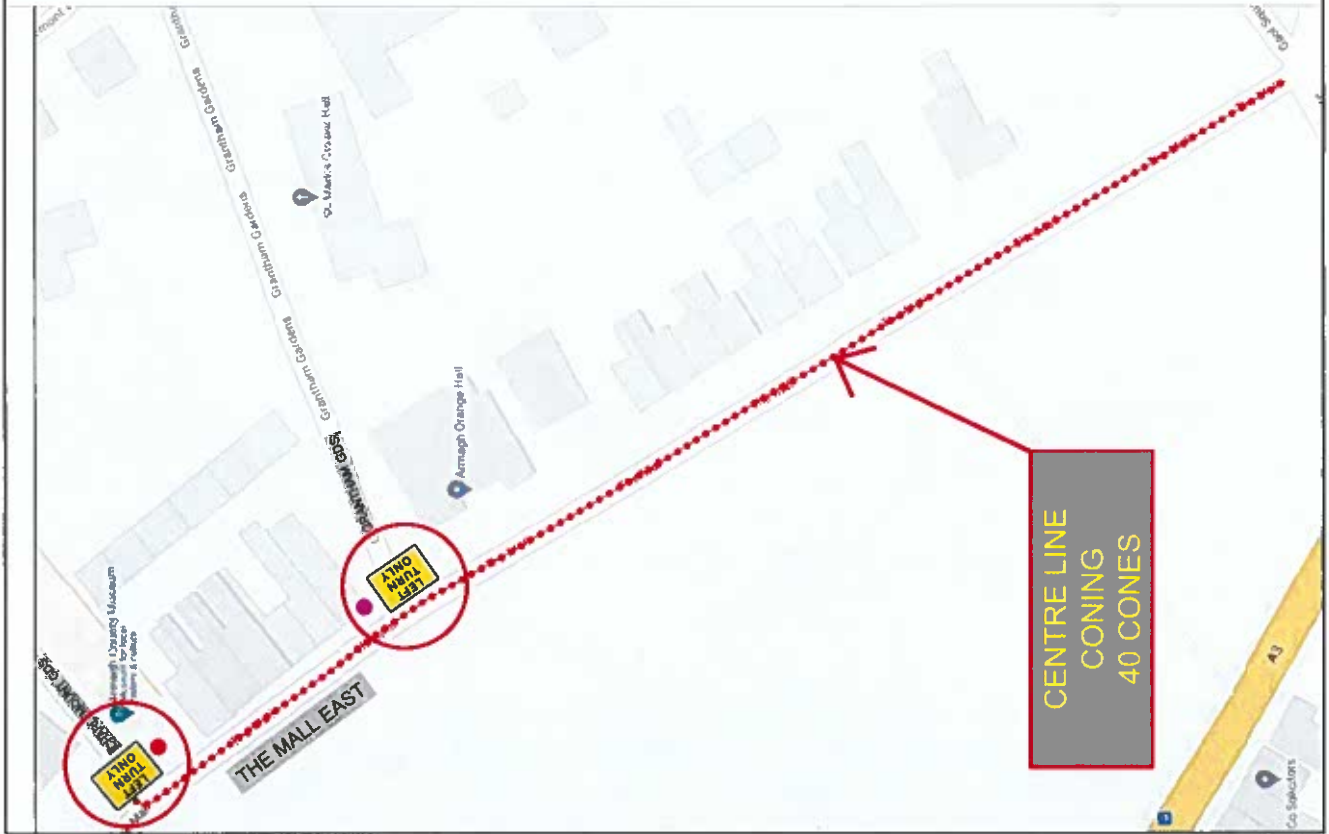

**KEY**

- Traffic cone
- █ Diversion Route
- █ Road Closure
- Installed daily from 3pm to 9pm on Fri 29th and Sat 30th
- Installed from Fri 29th at 6pm to Sun 1st Dec at 1am

REVIEW	EVENT
<b>GRAHAM</b>	
<b>ABC BOROUGH COUNCIL</b>	
<b>ARMAGH GEORGIAN DAY</b>	
<b>TRAFFIC MANAGEMENT DETAILS</b>	
<b>TM SETUP FOR EVENT</b>	
1- ARE ADVANCED NOTICE SIGNPOSTS SHOWING?	Y/N
2- ARE RELEVANT SIGNPOSTS SHOWING?	Y
3- ARE PAVEMENT LOCATIONS SHOWING?	N/A
4- ARE MARSHAL LOCATIONS SHOWING AT CENTRE LINE?	Y
5- ARE MARSHAL LOCATIONS SHOWING AT CENTRE LINE?	Y
<ul style="list-style-type: none"> <li>● Marshalls at Road Closed Signs (Marshalls to advise motorists of permitted movements - no vehicles allowed other than those from a side street)</li> <li>○ Marshalls at Centre Line Coning (Marshalls to advise motorists of permitted movements - no vehicles allowed other than those from a side street)</li> </ul>	
<p><b>EVENT ORGANISER</b></p> <p>EVENT TRAFFIC MANAGEMENT DOES NOT COMPLY WITH C&amp;E PLEASE REFER TO CLAUSE 2.3 OF OUR TERMS OF BUSINESS FOR FURTHER INFORMATION</p>	
N.T.S.	17/06/2022
JCH	A3
<b>ABCBC - GEORGIAN DAY - 03</b>	
<b>0</b>	







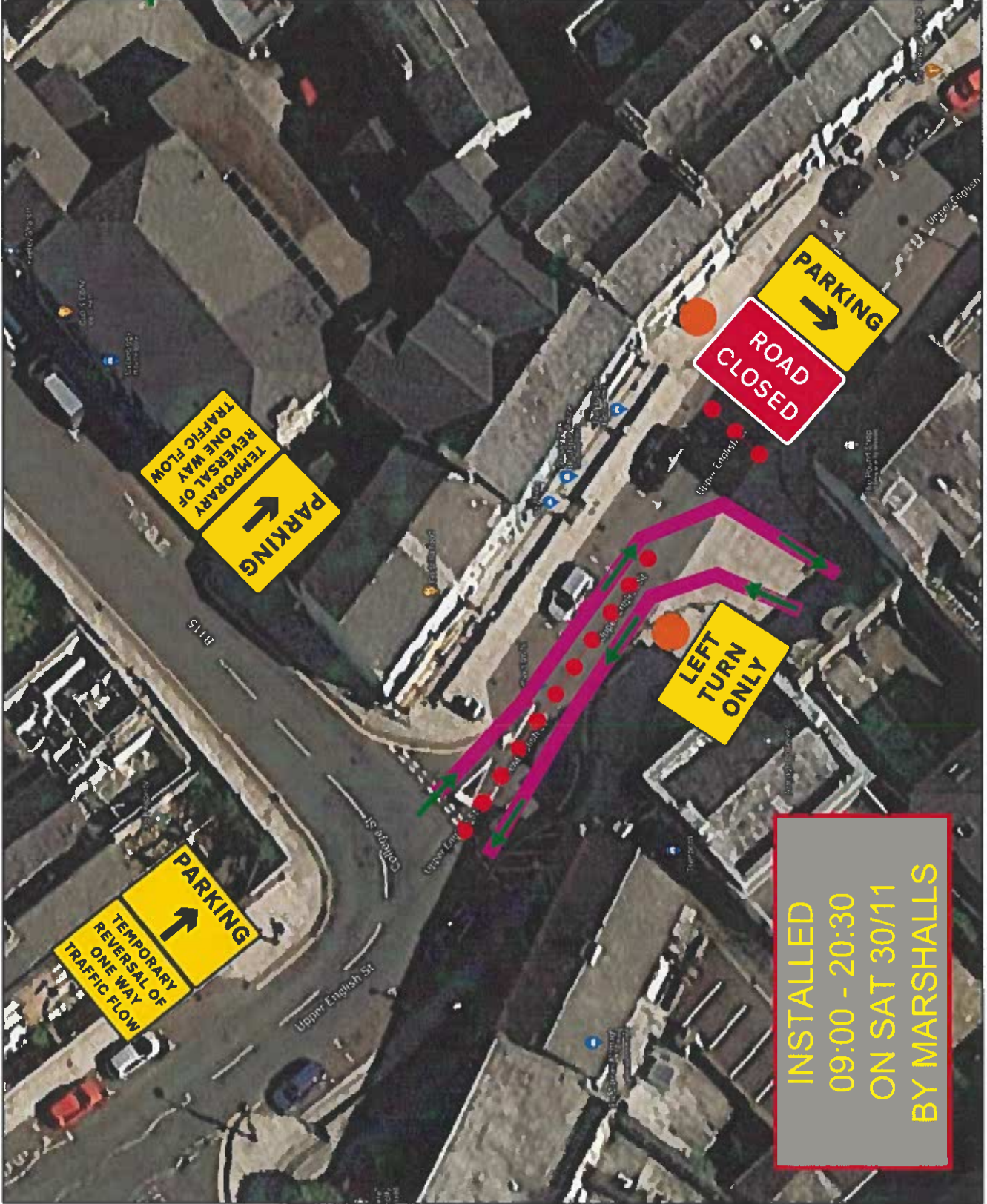









**KEY**

- Traffic cone
- Traffic route
- Installed daily from 3pm to 9pm on Fri 29th and Sat 30th
- Installed from Fri 29th at 6pm to Sun 1st Dec at 1am



REVIEW	EVENT
<b>GRAHAM</b>	
ABC BOROUGH COUNCIL	
ARMAGH GEORGIAN DAY	
TRAFFIC MANAGEMENT DETAILS	
TM SETUP FOR EVENT	
1- ARE ADVANCED NOTICE SIGNAGES SHOWN?	Y/N
2- ARE RELEVANT DISCLAIMERS SHOWN?	Y
3- ARE PAV LOCATIONS SHOWN?	N/A
4- ARE MARSHALL LOCATIONS SHOWN AT ROAD CLOSED POINTS?	Y
5- ARE MARSHALL LOCATIONS SHOWN AT CENTRE LINE CORNER?	Y
6- ARE MARSHALLS AT ROAD CLOSED SIGNS (Marshall's to advise motorists of permitted movements) 1-0 (no vehicles allowed into location route from a side street)	
7- ARE MARSHALLS AT CENTRE LINE CORNER (Marshall's to advise motorists of permitted movements) 1-0 (vehicles from side street only allowed to turn left)	
<b>EVENT ORGANISER</b>	
EVENT TRAFFIC MANAGEMENT DOES NOT COMPLY WITH C&E PLEASE REFER TO CLAUSE 23 OF OUR TERMS OF BUSINESS FOR FURTHER INFORMATION	
N.T.S.   17/08/2022	JCH
ABCBC - GEORGIAN DAY - 04	0

Qty: 4 Ref: 13.9 Schedule 13-9 : Temporary Information	
Qty: 2 Ref: 13.9 Schedule 13-9 : Temporary Information	
Qty: 1 Ref: 13.9 Schedule 13-9 : Temporary Information	
Qty: 2 Ref: 13.9 Schedule 13-9 : Temporary Information	
Qty: 2 Ref: 13.9 Schedule 13-9 : Temporary Information	
Qty: 2 Ref: 2702 End of temporary diversion route	
Qty: 2 Ref: 2702 Start of temporary diversion route	
Qty: 2 Ref: 2703 Direction of temporary diversion route from junction ahead	
Qty: 1 Ref: 2703 Direction of temporary diversion route from junction ahead	
Qty: 1 Ref: 2703 Direction of temporary diversion route from junction ahead	
Qty: 1 Ref: 517 Road narrows on one side only ahead - left	
Qty: 1 Ref: 7001 Road works ahead	
Qty: 5 Ref: 7010-FP-13-9 Nature of temporary hazard ahead - Road Ahead Closed	
Qty: 18 Ref: 7010-FP-13-9 Nature of temporary hazard ahead - Road Closed	

**Road Traffic Regulation (Northern Ireland)  
Order 1997  
Notice of Proposed Special Event**

Armagh City Banbridge and Craigavon Borough Council has received an application from the Events team at Armagh City, Banbridge and Craigavon Borough Council that it wishes to hold Georgian Day on Ogle Street, Thomas Street, Scotch Street, Market Street, Castle Street, Upper English Street, Russell Street and Mall East, Armagh on Friday 29 November 2024 and Saturday 30 November 2024.

By virtue of the powers conferred on it by Article 8A of and Schedule 3A to the Road Traffic Regulation (Northern Ireland) Order 1997 the Council gives notice that it is minded to make an Order to temporarily restrict or prohibit traffic as follows on Friday 29 November 2024 and Saturday 30 November 2024.

- Castle Street closed on Friday 29 November and Saturday 30 November from 3.00pm until 9.00pm each day. Residents will be facilitated who need access during these hours. There will be no traffic allowed in the area at the top of Market Square i.e from Castle Tower Restaurant to just above the entrance to the Market Place Theatre Private Car Park.
- Market Street through to Upper English Street junction with Russell Street closed Friday 29 November from 3.00pm until Sunday 1 December at 1.00am. Some deliveries may be facilitated on request.
- Upper English Street from junction of Russell Street to entrance of St Patricks Trian/ Market Place Theatre Car Park Closed on Friday 29 November at 6.00pm until Sunday 1 December at 1.00am. Some deliveries may be facilitated on request.
- To allow access to the St Patrick's Trian/ Marketplace Theatre Car Park on Upper English Street during its opening hours (9.00am – 8.30pm) on Saturday 30 November, a temporary reversal of one way traffic flow from the junction of College Hill/ Upper English Street to the St Patrick's Trian/ Market Place Theatre Car Park (car-park approx. 30 metres from the junction of College Hill/ Upper English Street).
- Top of Jenny's Row Closed on Friday 29 November at 6.00pm until Sunday 1 December at 1.00am.
- Russell Street Closed on Friday 29 November at 6.00pm until Sunday 1 December at 1.00am. Some deliveries may be facilitated on request.
- Mall East lane closure (Lane next to Mall green) traffic enter from College Hill end, one way from Friday 29 November at 6.00pm until Sunday 1 December at 1.00am.
- Scotch Street, Thomas Street and Ogle Street will be closed on Friday 29 November at 6.00pm until Sunday 1 December at 1.00am.

A diversion route will be signposted via Victoria Street, Drumadd Road, College Hill and The Mall West, Armagh.

Copies of the application may be inspected free of charge at the Environmental Health Office, The Old Armagh City Hospital, 39 Abbey Street, Armagh, BT61 7DY or viewed online at [www.armaghbanbridgecraigavon.gov.uk](http://www.armaghbanbridgecraigavon.gov.uk)

Persons wishing to make representations to the Council regarding the proposal may make representations in writing at the address below by 5pm on Friday 22 November 2024, representations received after this will not be considered.

The Chief Executive  
The Old Armagh City Hospital  
39 Abbey Street  
Armagh  
BT61 7DY

